

J46 series rectangle locomotive connector

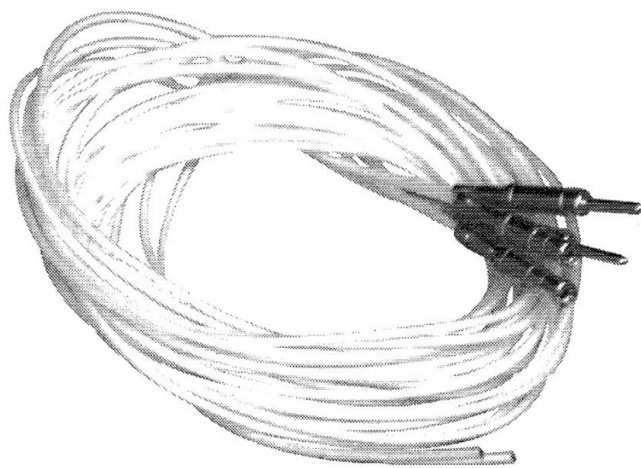
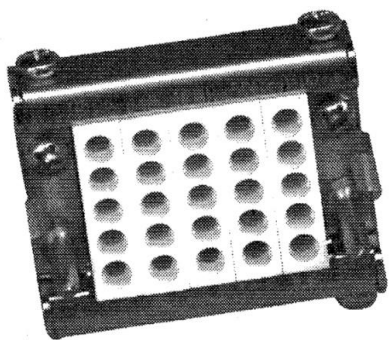

Part number

	J46	-10M	P	5D	P
Basic series					
Type of shell 10M = Shell No.					
Type of connector P = Plug R = Receptacle					
Module number of contact 5D = 5 contacts of $\Phi 1.5$					
Type of contact P = Pin S = Socket					

Electrical performance

Rated operating current: 15 A

Rated operating voltage: 300 V

Contact resistance: $\leq 2.5 \text{ m}\Omega$

Insertion and withdrawal force of contact: 0.45N ~ 1.2N

Mechanical performance

Endurance: 750 cycles

Diameter of conductor: 1.5 mm^2

Environmental performance

Operating temperature: $-40^\circ\text{C} \sim +100^\circ\text{C}$

Humidity: 95% at 40°C ; 92% ~ 95% at $40^\circ\text{C} \pm 2^\circ\text{C}$

Material

Shell: Thermo-plastic

Contact: Copper-alloy

Finish of contact: Gold plating

Contact layout



Size

J46-10MR-5DS

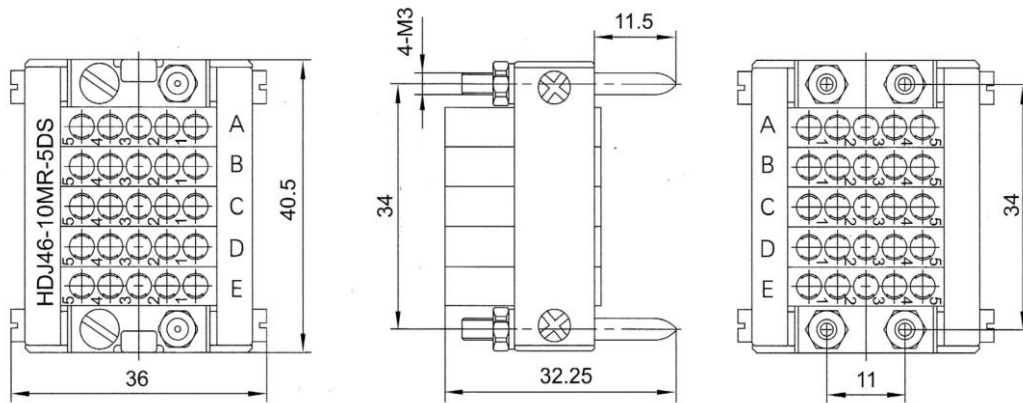

J46-10MP-5DP

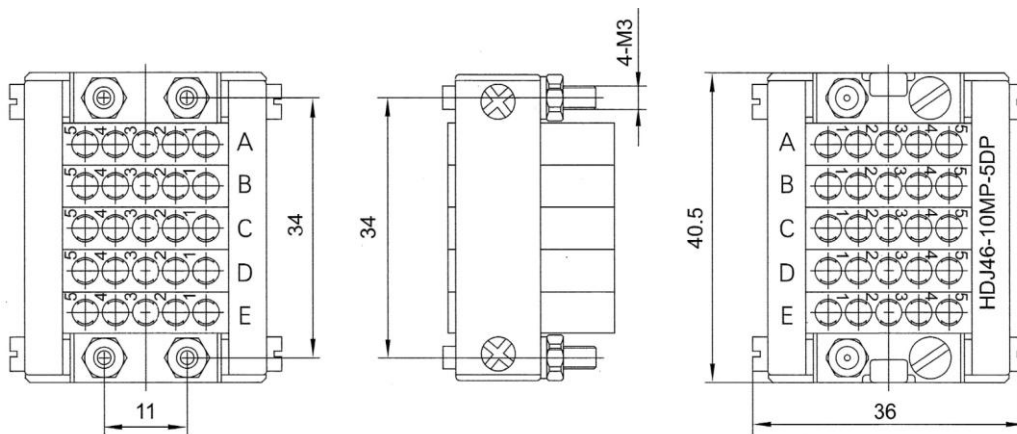

Pin - $\Phi 1.5$

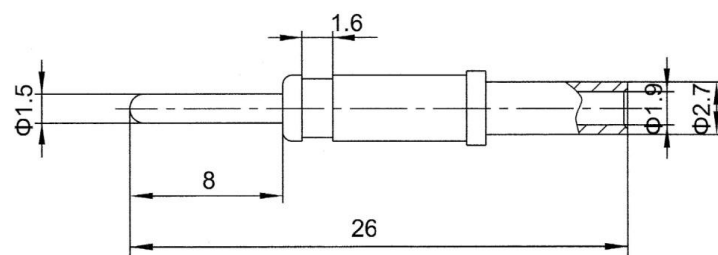

Socket - $\Phi 1.5$

